

RHR

 Radial Lead Type series

- Super low ESR, High ripple current
- Large capacitance, Small size
- Load life of 10,000h at 105°C

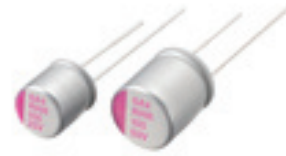

SPECIFICATIONS

Items	Characteristics	
Temperature range	-55 to +105°C	
Rated voltage range	2.5 to 16Vdc	
Capacitance range	100 to 3,500μF	
Capacitance tolerance	±20% [M] (at 20°C, 120Hz)	
Tangent of loss angle	Less than or equal to the value of Standard Ratings (at 20°C, 120Hz)	
Leakage current	Less than or equal to the value of Standard Ratings (at 20°C, after 2 minutes)	
ESR	Less than or equal to the value of Standard Ratings	
Characteristics of impedance	E+105°C/Z+20°C ≤ 1.25, Z-55°C/Z+20°C ≤ 1.25 at 100kHz	
Endurance	105°C, 10,000 hrs at rated voltage	
	Appearance	No significant damage
	Capacitance change	Within±20% of the initial value
	Tangent of loss angle (tanδ)	≤150% of the initial specified value
	ESR(mΩ)	≤150% of the initial specified value
	Leakage current	≤The initial specified value
Damp Heat (Steady State)	60°C, 90 to 95% RH, 1,000 hrs, No-applied Voltage	
	Appearance	No significant damage
	Capacitance change	Within±20% of the initial value
	Tangent of loss angle (tanδ)	≤150% of the initial specified value
	ESR(mΩ)	≤150% of the initial specified value
	Leakage current	≤The initial specified value
Resistance to soldering heat	Flow method (260±5°C, 10s)	
	Appearance	No significant damage
	Capacitance change	Within±10% of the initial value
	Tangent of loss angle (tanδ)	≤130% of the initial specified value
	ESR(mΩ)	≤130% of the initial specified value
	Leakage current	≤The initial specified value

*In case of some problems for measured values, measure after applying rated voltage for 120 minutes at 105°C

SIZE LIST

(unit : mm)

μF	RV(SV)	2.5 (3.3)	4 (5.2)	6.3 (8.2)	10 (11.5)	16 (18.4)
100						6.3 x 6 6.3 x 9
150					6.3 x 6	8 x 7
180						8 x 9 8 x 11.5
220		5 x 9		6.3 x 6		
270					8 x 7	8 x 9 8 x 11.5
330		5 x 9 6.3 x 9				8 x 9 8 x 11.5
470		5 x 9		6.3 x 9 8 x 9 8 x 11.5		10 x 11.5
560		5 x 9 6.3 x 9 8 x 9	6.3 x 9 8 x 9 8 x 11.5	6.3 x 9 8 x 9		
680			8 x 11.5	10 x 11.5		
820		6.3 x 9 8 x 7 8 x 9 8 x 11.5	10 x 11.5	8 x 9 8 x 11.5		
1000		8 x 9	8 x 9 10 x 11.5			
12000			8 x 9			
1500		8 x 9		10 x 11.5		
2700		10 x 11.5				
3500		10 x 11.5				

*RV : Rated Voltage [V] SV : Surge Voltage [V] (at room temperature)

MARKING AND DIMENSIONS

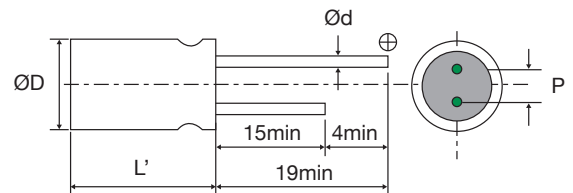
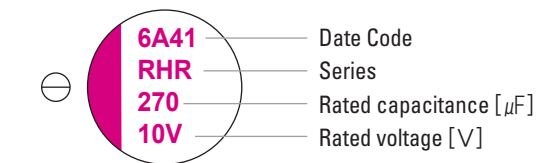

(unit : mm)

Size	φD±0.5	L	L'	P±0.5	φd
5 x 9	5.0	9.0	L max.	2.0	0.6
6.3 x 6	6.3	6.0		2.5	0.45
8 x 7	8.0	7.0		3.5	0.45
6.3 x 9	6.3	9.0		2.5	0.6
8 x 9	8.0	9.0		3.5	0.6
8 x 11.5	8.0	11.5	L + 1.0 max.	3.5	0.6
10x11.5	10.0	11.5		5.0	0.6

STANDARD RATINGS

Rated Voltage [Vdc]	Rated Capacitance [μF]	Size Φ D x L [mm]	ESR (20°C, 100kHz) [mΩ] [max.]	Rated Ripple Current (105°C, 100kHz) [mA rms]	Tangent of Loss Angel [max.]	Leakage Current [μA, max.]	Part Number	
2.5	220	5 x 9	7	4180	0.1	500	2RHR220MB9	
	330	5 x 9	7	4180	0.1	500	2RHR330MB9	
	330	6.3 x 9	7	5600	0.1	500	2RHR330MC9	
	470	5 x 9	7	4180	0.1	500	2RHR470MB9	
	560	5 x 9	7	4180	0.1	500	2RHR560MB9	
	560	6.3 x 9	7	5600	0.1	500	2RHR560MC9	
	560	8 x 9	7	6100	0.1	500	2RHR560MD9	
	820	6.3 x 9	7	5600	0.1	500	2RHR820MC9	
	820	8 x 7	8	5300	0.1	500	2RHR820MD7	
	820	8 x 9	7	6100	0.1	500	2RHR820MD9	
	820	8 x 11.5	7	6100	0.1	500	2RHR820MD11	
	1000	8 x 9	7	6100	0.1	500	2RHR1000MD9	
	1500	8 x 9	7	6100	0.1	750	2RHR1500MD9	
	2700	10 x 11.5	10	5560	0.1	1350	2RHR2700ME11	
	3500	10 x 11.5	10	5560	0.1	1750	2RHR3500ME11	
4	560	6.3 x 9	7	5600	0.1	500	4RHR560MC9	
	560	8 x 9	7	6100	0.1	500	4RHR560MD9	
	560	8 x 11.5	7	6100	0.1	500	4RHR560MD11	
	680	8 x 11.5	7	6100	0.1	544	4RHR680MD11	
	820	10 x 11.5	7	6640	0.1	656	4RHR820ME11	
	1000	8 x 9	7	6100	0.1	800	4RHR1000MD9	
	1000	10 x 11.5	7	6640	0.1	800	4RHR1000ME11	
	1200	8 x 9	7	6100	0.1	960	4RHR1200MD9	
	6.3	220	6.3 x 6	18	2980	0.1	277	6RHR220MC6
		470	6.3 x 9	7	5600	0.1	592	6RHR470MC9
470		8 x 9	7	5700	0.1	592	6RHR470MD9	
470		8 x 11.5	7	5700	0.1	592	6RHR470MD11	
560		6.3 x 9	7	5600	0.1	705	6RHR560MC9	
560		8 x 9	7	5700	0.1	705	6RHR560MD9	
680		10 x 11.5	7	6640	0.1	857	6RHR680ME11	
820		8 x 9	7	5700	0.1	1033	6RHR820MD9	
820		8 x 11.5	7	5700	0.1	1033	6RHR820MD11	
1500		10 x 11.5	10	5560	0.1	1890	6RHR1500ME11	
10	150	6.3 x 6	26	2400	0.1	300	10RHR150MC6	
	270	8 x 7	22	3220	0.1	500	10RHR270MD7	
16	100	6.3 x 6	24	2490	0.1	320	16RHR100MC6	
	100	6.3 x 9	10	4680	0.1	500	16RHR100MC9	
	150	8 x 7	22	3220	0.1	500	16RHR150MD7	
	180	8 x 9	10	5000	0.1	576	16RHR180MD9	
	180	8 x 11.5	16	4360	0.1	576	16RHR180MD11	
	270	8 x 9	10	5000	0.1	864	16RHR270MD9	
	270	8 x 11.5	11	5000	0.1	864	16RHR270MD11	
	330	8 x 9	11	4520	0.1	1056	16RHR330MD9	
	330	8 x 11.5	11	5000	0.1	1056	16RHR330MD11	
	470	10 x 11.5	10	6100	0.1	1504	16RHR470ME11	

